

SEAT

Designer: Spark / Aaron Tuck



SLAT OPTIONS

- Oiled hardwood
- Composite
- Clear anodised aluminium

FRAME OPTIONS

- Hot dip galvanised mild steel

FRAME FINISHES

- Galvanised
- Powdercoated

INSTALLATION

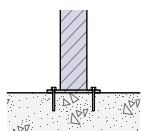

Bolt Down

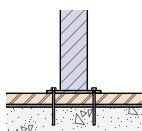

Bolt Through

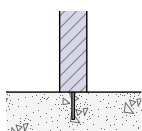

Concealed Fix

FIXINGS

- 12mm fixings for 14mm
- Diameter holes

Alternative materials and finishes available on request

UTILITY SEAT

SPECIFICATIONS

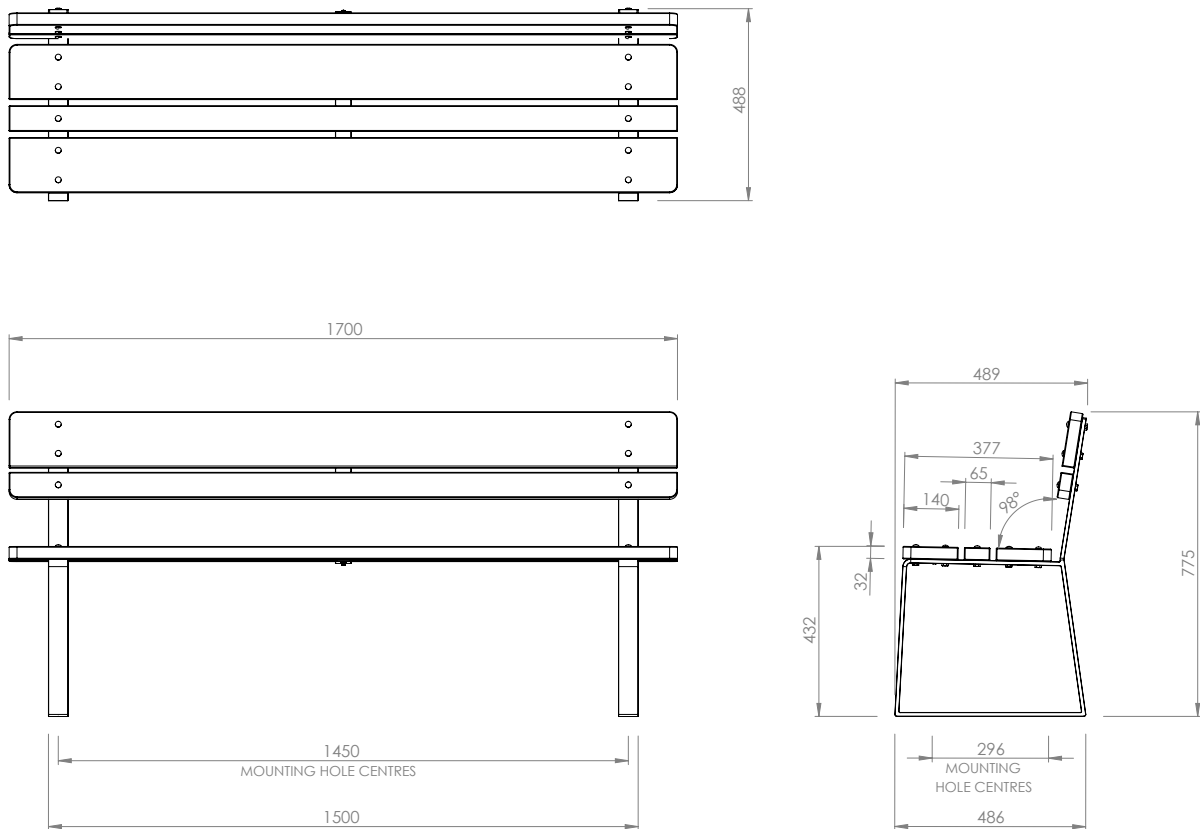

Measurements are in millimetres. Drawings are not to scale.

Dimensions shown are for timber option.

For composite and aluminium batten versions, battens are all one size.

PRODUCT CODE	FRAME FINISH	SLAT OPTION
UTL003-HDG-GV-T-18	Galvanised	Oiled hardwood timber
UTL003-HDG-PC-T-18	Powdercoated	Oiled hardwood timber
UTL003-HDG-GV-C-18	Galvanised	Composite
UTL003-HDG-PC-C-18	Powdercoated	Composite
UTL003-HDG-GV-A-18	Galvanised	Clear anodised aluminium
UTL003-HDG-PC-A-18	Powdercoated	Clear anodised aluminium